



REF: # 10861

CALPE/MORAIRA



#### INFO

PRIS:	980.000 €
BOLIG TYPE:	Villa
STED:	Calpe/Moraira
SOVEROM:	4
Bad:	3
BOAREAL ( m2 ):	248
TOMT ( m2 ):	-
Terrasse ( m2 ):	-
ÅR:	-
ETASJER:	-
MELDING	-

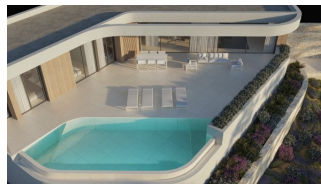

#### BESKRIVELSE

Modern villa (to be build) for sale in Moraira with guest apartment  
Location This attractive, newly built villa is situated Sol Park, Moraira. A popular neighbourhood on walking / cycling distance from the centre and the beach of Moraira. Two big supermarkets are 3 minutes by car. Within walking distance there is a bank, cafetaria, pharmacy and tennis and padel club. The villa The ground floor hosts a good-sized living-dining room with open kitchen with island. There are 3 double bedrooms and 2 bathrooms. The main bedroom has a bathroom en-suite. From all rooms you can access the pool terrace. Also guest toilet on this floor. The underbuild has a separate guest apartment consisting of an open plan seating area, kitchen and bedroom plus a bathroom. We also find the laundry and technical room on this level. Outside From the terrace (partly covered) you can enjoy the nice open views. Freeform infinity pool and a low maintenance garden. Features Underfloor heating, double glazing, air con, Bosch kitchen appliances (hob, extractor, fridge, oven, microwave and dishwasher), LED lighting inside and outside as well as LED strips, heat pump (A+++), electric shutters in the bedrooms,

programmed irrigation system for the garden, video intercom and Jablotron 100+ alarm system. This elegant, modern villa for sale&nbsp;offers a lot of comfort on a desired spot in Moraira. Talk to one of the sales agents for more information. There is also model of this property developed without a guest apartment but with a garage for 2 cars instead (ref. P-15065-a).

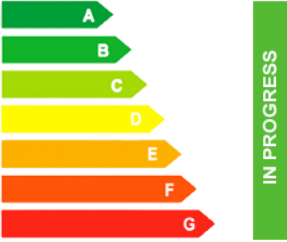

UTSIKT	PARKERING NR BILER	OPPVARMING	ENERGETIC CERTIFIED
<ul style="list-style-type: none"> <li>Panorama</li> </ul>	Garasje nr biler : 1	<ul style="list-style-type: none"> <li>Sentral gas oppvarming</li> </ul>	 <p>The image shows a vertical energy efficiency scale with seven horizontal bars of increasing length, labeled A through G from top to bottom. The bars are colored in a gradient from dark green (A) to red (G). To the right of the scale is a vertical green bar with the text 'IN PROGRESS' written vertically inside it.</p>

**"OUR EXPERIENCE IS YOUR GUARANTEE"**